



GLEND A S. TIMMER REVOCABLE TRUST - TRACT 3

## AERIAL MAP



Center: 42.718712, -92.685136

01-91N-16W

Jefferson Township

Butler County, IA



FarmWorth, LLC makes no representations or warranties, express or implied, as to the accuracy of any information, data, numerical values, boundaries, or any other information generated through the use of FarmWorth.com. User is solely responsible for independently investigating and determining all information provided through FarmWorth.com prior to use and waives any and all claims against FarmWorth, LLC for any inaccuracies or inconsistencies in the information and/or data.



# GLEND A S. TIMMER REVOCABLE TRUST - TRACT 3

## TOTAL SOILS

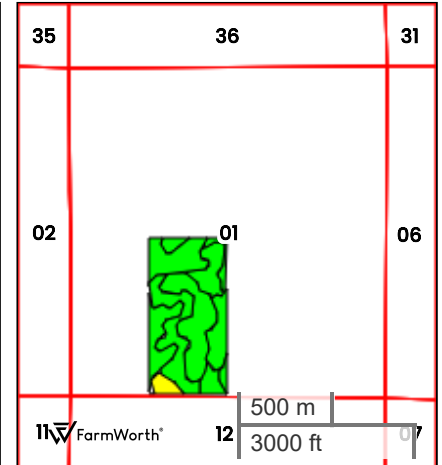
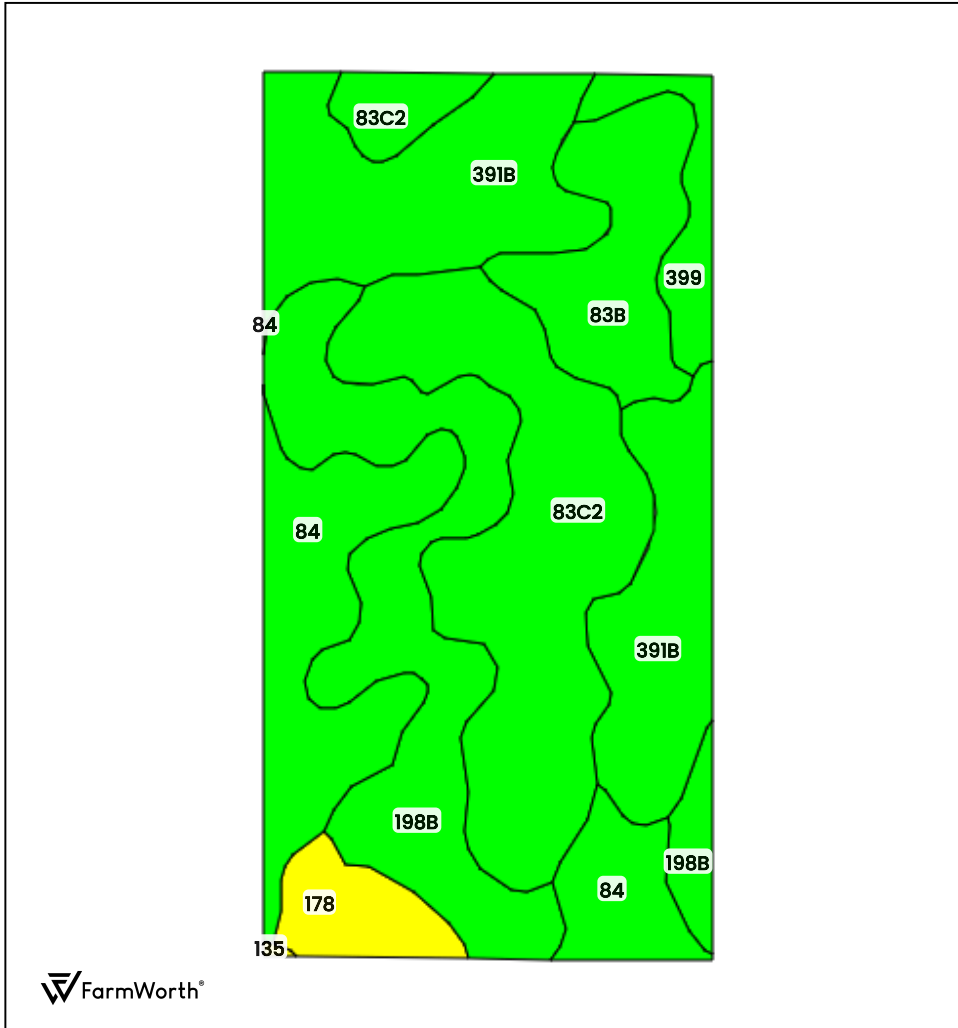

County: **Butler County, IA**  
Location: **01-91N-16W**  
Township: **Jefferson**  
Acres: **79.34**  
Date: **12/02/2025**



Field borders obtained from Farm Service Agency  
as of 2008

FarmWorth, LLC makes no representations or warranties, express or implied, as to the accuracy of any information, data, numerical values, boundaries, or any other information generated through the use of FarmWorth.com. User is solely responsible for independently investigating and determining all information provided through FarmWorth.com prior to use and waives any and all claims against FarmWorth, LLC for any inaccuracies or inconsistencies in the information and/or data.

Code	Description	Acres	% of field	IA CSR2	Soil Class (Non-Irr)	Drainage Class
83C2	Kenyon loam, 5 to 9 percent slopes, eroded	19.32	24.36 %	84	3	Moderately well drained
391B	Clyde-Floyd complex, 1 to 4 percent slopes	18.56	23.40 %	87	2	Poorly drained
198B	Floyd loam, 1 to 4 percent slopes	16.10	20.30 %	89	2	Somewhat poorly drained
84	Clyde silty clay loam, 0 to 3 percent slopes	12.62	15.91 %	88	2	Poorly drained
83B	Kenyon loam, 2 to 5 percent slopes	7.05	8.89 %	90	2	Moderately well drained
178	Waukee loam, 0 to 2 percent slopes	2.98	3.76 %	69	2	Well drained
399	Readlyn silt loam, 1 to 3 percent slopes	2.62	3.30 %	91	1	Somewhat poorly drained
135	Coland clay loam, 0 to 2 percent slopes, occasionally flooded	0.07	0.09 %	65	2	Poorly drained
				Average:	86.5	

IA has updated the CSR values for each county to CSR2.

Soils data provided by USDA and NRCS.



# GLEND A S. TIMMER REVOCABLE TRUST - TRACT 3

## TILLABLE SOILS

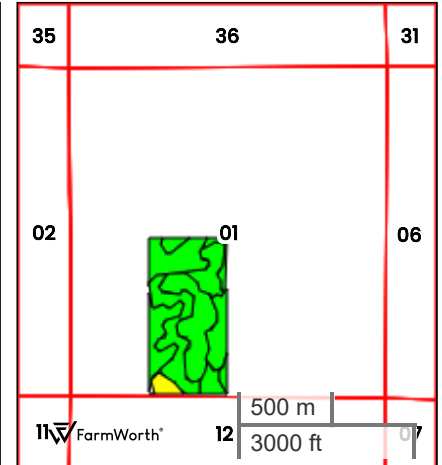
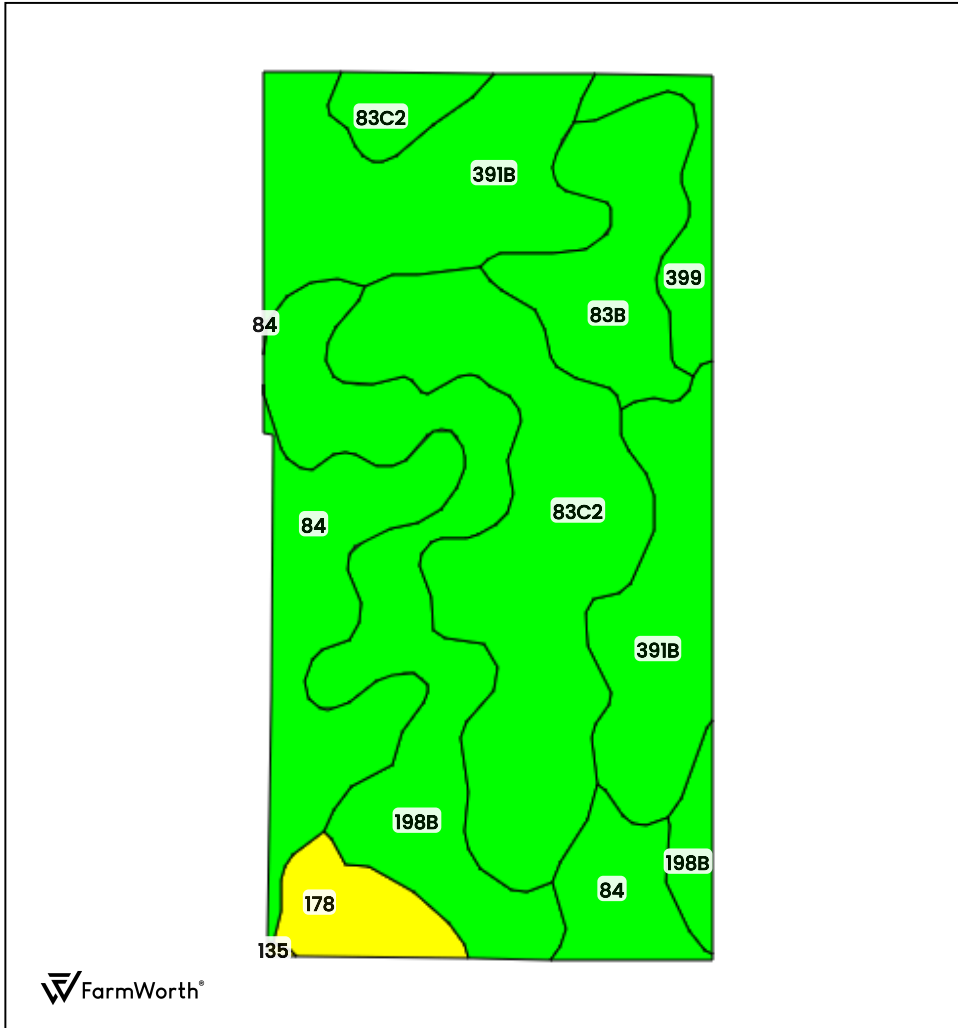

County: **Butler County, IA**  
Location: **01-91N-16W**  
Township: **Jefferson**  
Acres: **78.52**  
Date: **12/02/2025**



Field borders obtained from Farm Service Agency as of 2008

FarmWorth, LLC makes no representations or warranties, express or implied, as to the accuracy of any information, data, numerical values, boundaries, or any other information generated through the use of FarmWorth.com. User is solely responsible for independently investigating and determining all information provided through FarmWorth.com prior to use and waives any and all claims against FarmWorth, LLC for any inaccuracies or inconsistencies in the information and/or data.

Code	Description	Acres	% of field	IA CSR2	Soil Class (Non-Irr)	Drainage Class
83C2	Kenyon loam, 5 to 9 percent slopes, eroded	19.32	24.61 %	84	3	Moderately well drained
391B	Clyde-Floyd complex, 1 to 4 percent slopes	18.55	23.63 %	87	2	Poorly drained
198B	Floyd loam, 1 to 4 percent slopes	16.10	20.51 %	89	2	Somewhat poorly drained
84	Clyde silty clay loam, 0 to 3 percent slopes	11.83	15.07 %	88	2	Poorly drained
83B	Kenyon loam, 2 to 5 percent slopes	7.05	8.98 %	90	2	Moderately well drained
178	Waukee loam, 0 to 2 percent slopes	2.98	3.80 %	69	2	Well drained
399	Readlyn silt loam, 1 to 3 percent slopes	2.62	3.34 %	91	1	Somewhat poorly drained
135	Coland clay loam, 0 to 2 percent slopes, occasionally flooded	0.06	0.08 %	65	2	Poorly drained
				Average:	86.5	

IA has updated the CSR values for each county to CSR2.

Soils data provided by USDA and NRCS.



GLEND A S. TIMMER REVOCABLE TRUST - TRACT 3  
CRP SOILS

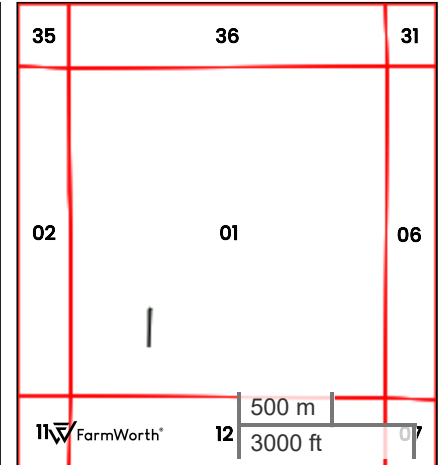
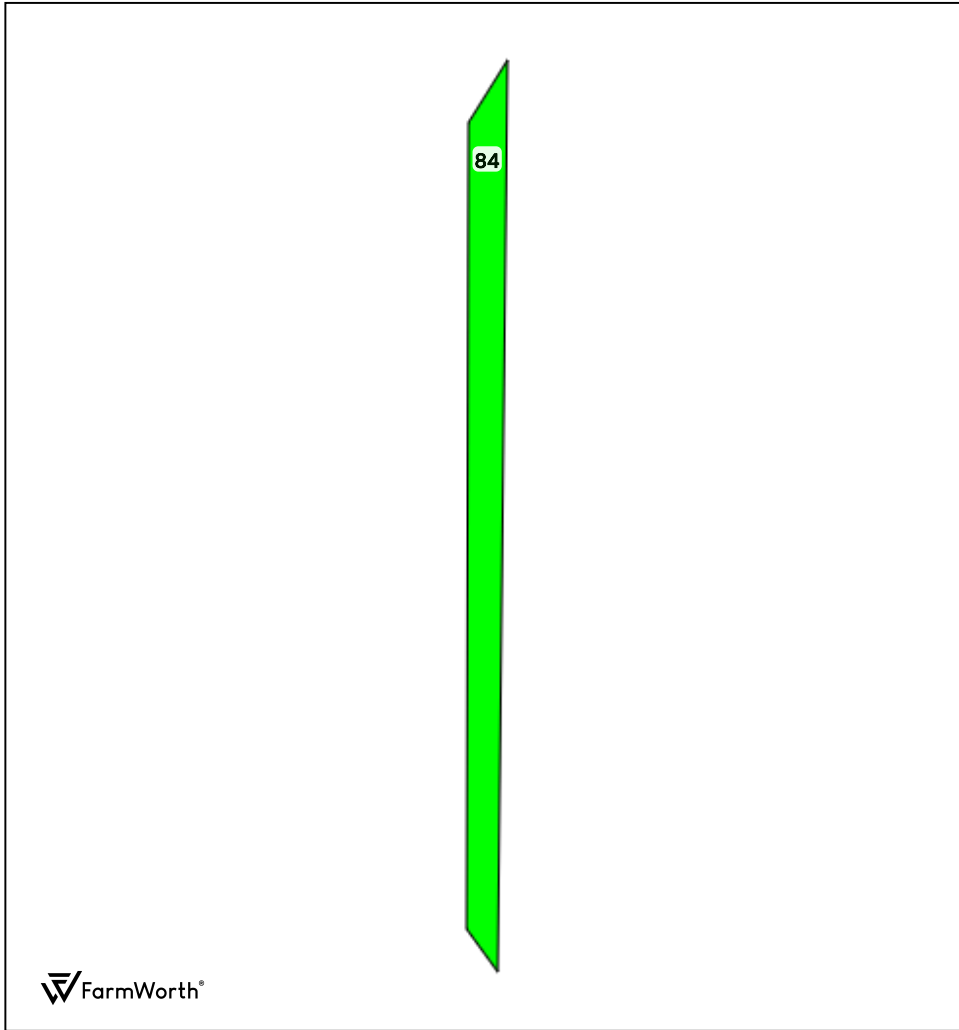

County: **Butler County, IA**  
Location: **01-91N-16W**  
Township: **Jefferson**  
Acres: **0.38**  
Date: **12/02/2025**



Field borders obtained from Farm Service Agency  
as of 2008

FarmWorth, LLC makes no representations or  
warranties, express or implied, as to the accuracy of  
any information, data, numerical values, boundaries,  
or any other information generated through the use of  
FarmWorth.com. User is solely responsible for  
independently investigating and determining all  
information provided through FarmWorth.com prior to  
use and waives any and all claims against FarmWorth,  
LLC for any inaccuracies or inconsistencies in the  
information and/or data.

Code	Description	Acres	% of field	IA CSR2	Soil Class (Non-Irr)	Drainage Class
84	 Clyde silty clay loam, 0 to 3 percent slopes	0.38	100.00 %	88	2	Poorly drained
Average:				88.0		

IA has updated the CSR values for each county to CSR2.  
Soils data provided by USDA and NRCS.





GLEND A S. TIMMER REVOCABLE TRUST - TRACT 3  
FLOOD HAZARDS



FarmWorth, LLC makes no representations or warranties, express or implied, as to the accuracy of any information, data, numerical values, boundaries, or any other information generated through the use of FarmWorth.com. User is solely responsible for independently investigating and determining all information provided through FarmWorth.com prior to use and waives any and all claims against FarmWorth, LLC for any inaccuracies or inconsistencies in the information and/or data.

Significant Flood Hazards

- Regulatory Floodway (Zones AE, AO, AH, VE, AR)
- Without Base Flood Elevation (BFE), with BFE or Depth (Zones A, V, A99)





GLEND A S. TIMMER REVOCABLE TRUST - TRACT 3

## TOPOGRAPHY



960 ft

1017 ft



Center: 42.718712, -92.685132

01-91N-16W

Jefferson Township

Butler County, IA

Source: USGS 10m DEM

Interval(ft): 3

Max: 1017.0 ft

Min: 960.0 ft

Range: 57.0 ft

Average: 988.5 ft



FarmWorth, LLC makes no representations or warranties, express or implied, as to the accuracy of any information, data, numerical values, boundaries, or any other information generated through the use of FarmWorth.com. User is solely responsible for independently investigating and determining all information provided through FarmWorth.com prior to use and waives any and all claims against FarmWorth, LLC for any inaccuracies or inconsistencies in the information and/or data.

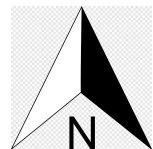



# GLEND A S. TIMMER REVOCABLE TRUST - TRACT 3

## PLAT MAP

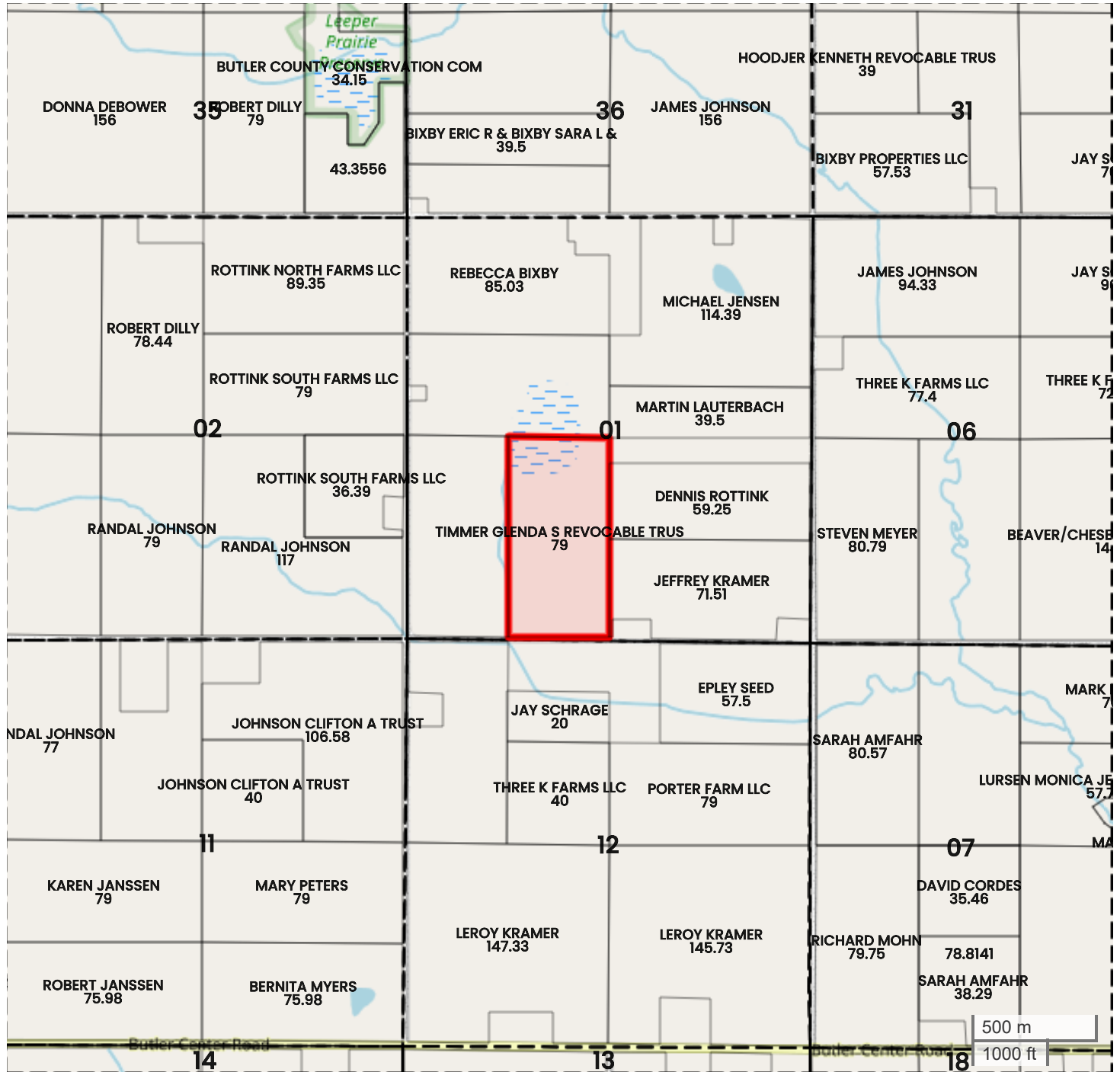

Center: 42.718692, -92.685119

01-91N-16W  
Jefferson Township  
Butler County, IA



FarmWorth, LLC makes no representations or warranties, express or implied, as to the accuracy of any information, data, numerical values, boundaries, or any other information generated through the use of FarmWorth.com. User is solely responsible for independently investigating and determining all information provided through FarmWorth.com prior to use and waives any and all claims against FarmWorth, LLC for any inaccuracies or inconsistencies in the information and/or data.





GLEND A S. TIMMER REVOCABLE TRUST - TRACT 3  
PROXIMITY MAP



FarmWorth, LLC makes no representations or warranties, express or implied, as to the accuracy of any information, data, numerical values, boundaries, or any other information generated through the use of FarmWorth.com. User is solely responsible for independently investigating and determining all information provided through FarmWorth.com prior to use and waives any and all claims against FarmWorth, LLC for any inaccuracies or inconsistencies in the information and/or data.

[Get Driving Directions](#)





GLEND A S. TIMMER REVOCABLE TRUST - TRACT 3  
REGIONAL MAP



FarmWorth, LLC makes no representations or warranties, express or implied, as to the accuracy of any information, data, numerical values, boundaries, or any other information generated through the use of FarmWorth.com. User is solely responsible for independently investigating and determining all information provided through FarmWorth.com prior to use and waives any and all claims against FarmWorth, LLC for any inaccuracies or inconsistencies in the information and/or data.

 [Get Driving Directions](#)